



A unique, quirky, and versatile venue set at the heart of East London's creative community in Brick Lane, 93 Feet East offers a variety of unique, multi-functional event spaces. This, alongside the experience and expertise of our in-house events team means we have the tools to provide you with a comprehensive solution for your event, be it private or corporate. With two large inside spaces, an expansive open-air courtyard, terrace and our collection of smaller more 'boutique' rooms meaning we can offer you the creative space and service that you and your guests will remember, for all the right reasons.

Our History

Built nearly 200 years ago at the very start of Queen Victoria's reign in the 1830s, the oldest parts of the venue occupy what was originally built as large family home for The Truman Brewery's chief engineer. A Grade II listed building, 93 Feet East offers not only flexible, practical event space but also a unique back drop with numerous original features and design elements.

A reminder of its origins as the biggest brewery in the world during its height we've taken our name from the original marker still on display in our courtyard denoting that the freehold of Messrs Truman, Hanbury, Buxton and amp; Co 'extends 93 feet east and 17 feet and six inches north of this stone'.

Our recent refurbishment and rebrand has been a nod to our roots and history, both more recent and stretching back nearly two centuries at our location in East London. With our industrial heritage and modern style reflected in the raw, stripped back interior elements where vast concrete walls and original parquet flooring merge the old and new





The Courtyard



Standing 450



Seated 250



Natural light



Screen & projector



DJ Set up



Private toilets



Outside space is now more of a sought-after commodity than ever amongst event bookers and party planners and ours provides a large, unique space that steps directly off the buzz of Brick Lane. Ideal for food markets, daytime gatherings or a party under the stars, the Courtyard works as its own functional space, or as a place to offer guests the chance to sit away from the entertainment inside.

A stairway leads up to a smaller additional outdoor terrace, looking over the main space that is available on request. Now featuring three fully covered and heated areas the Courtyard useable to weatherproof.



The Bar



Standing 330 – 375



Theatre Style 100
Classroom 50
Cabaret 72



Natural light



Screen & projector



DJ Set up



Large industrial windows running along the outer wall, looking out over the courtyard flood the space with natural light, which can be diffused with a sheer blind option or fully blacked out, depending on your needs.

The Bar has a large DJ booth, lighting system, full sound and projection capabilities, large bar and multiple seating or standing options. This makes a fully flexible space, suitable for a multitude of uses, day or night, whatever the weather.





Standing 375 – 410



Seated
Theatre Style 100
Classroom 50
Cabaret 75



Screen & projector



DJ Set up



Private toilets



Stage



Green room

93 Live



Our largest indoor space is not only available to hire in conjunction with the rest of 93 Feet East but also as a stand-alone venue with its own access from Brick Lane, a reception area and cloakroom. Ideal for performances and music events, screenings, showcases and parties. Modular staging, no external windows and a wide range of AV, lighting, and sound options available in this room make it the perfect creative space.

Hosting your event

Our team are on hand to support you with all the elements of your event planning. Our little black book is always up to date with the best suppliers, including caterers, decor & production, furniture rental, AV and much more.

Whether a private party, conference, exhibition, all day meeting or away day, product launch, art installation or a fully seated dinner. From your initial brief right up to execution, our instinctive understanding of the client's needs means the delivery of your event will be smooth, professional, and inspiring at every turn.



Floor plan

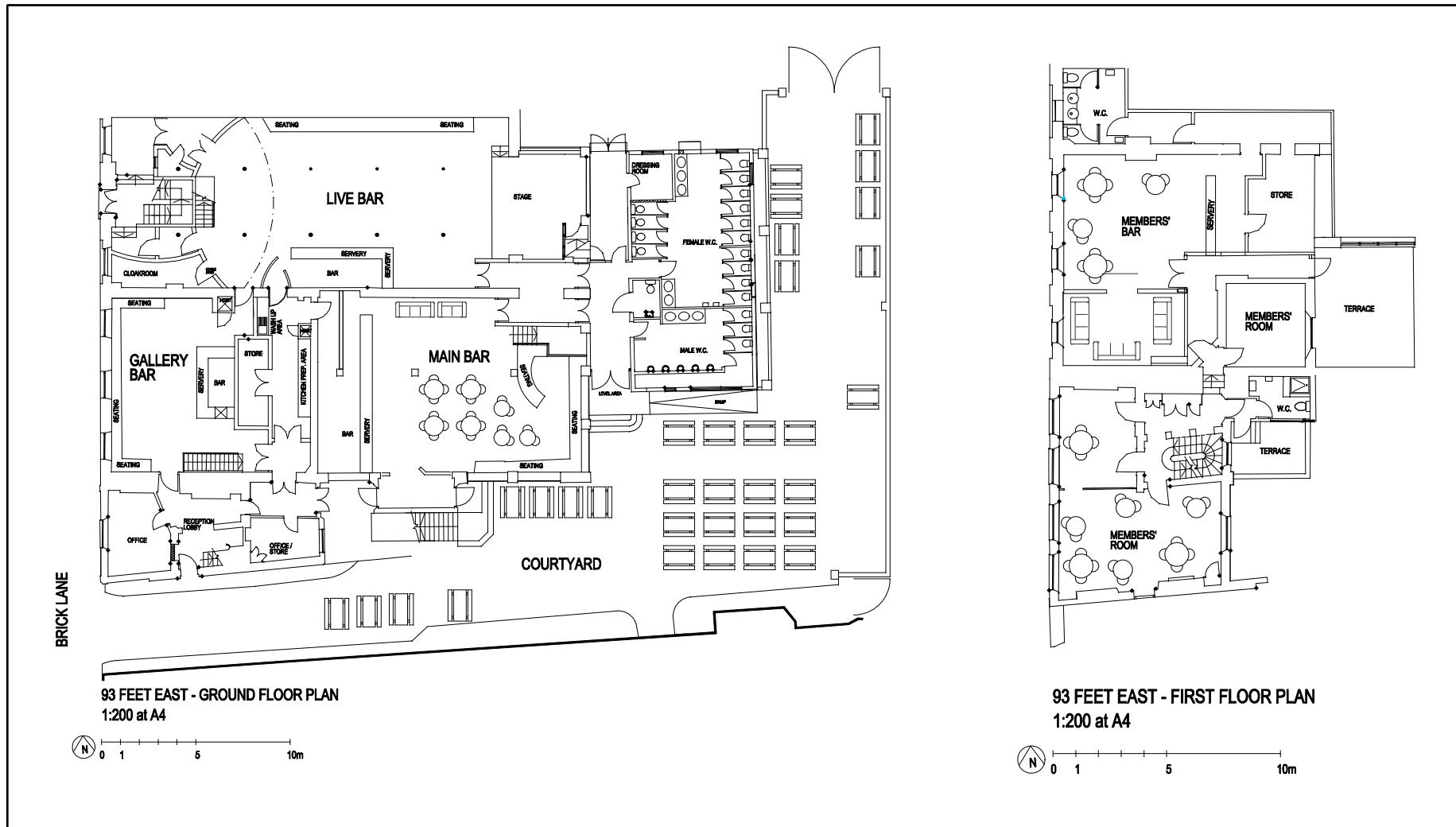



CONTACT

adam@93feeteast.co.uk